

EMU/M-0-3-053



② 9/68
QTY. FOR DC/EMU/M ADDED
IN COL-I.
CDA: Sd/- 3.9.68

▽ ROUGH MACHINED
▽▽ FINISH MACHINED
▽▽▽ FINE FINISH MACHINED

① ROUGH CLEANED
⑱ CHAMFERED
①⑩ BURRS REMOVED

ALT.	DATE	CHANGES	BY/APP.
M2	16/05	MATL. SPECN. STOCK NO. CHANGED. ECN. NO. 90600366.	

ALTERATIONS	
g	8/64 DRILL JIG 6348 ADDED. CDA: Sd/- 28.8.64
b	10/66 SHAPE MODIFIED. CDA: Sd/- 14.10.66
c	1/68 QTY. FOR ITEM-1 ALTD. FROM 8 TO 24. CDA: Sd/- 23.1.68
d	8/02 DRAWING REDRAWN IN CAD. FOR ITEM-1 MAT. SPEC. ALTD. FROM IS:2062-62 St-42-Wc TO IRS M41-97. DRILL JIG. NO. 6348 DELETED. NOTE-1 ADDED. SSE/D 20/8 SME/BD.

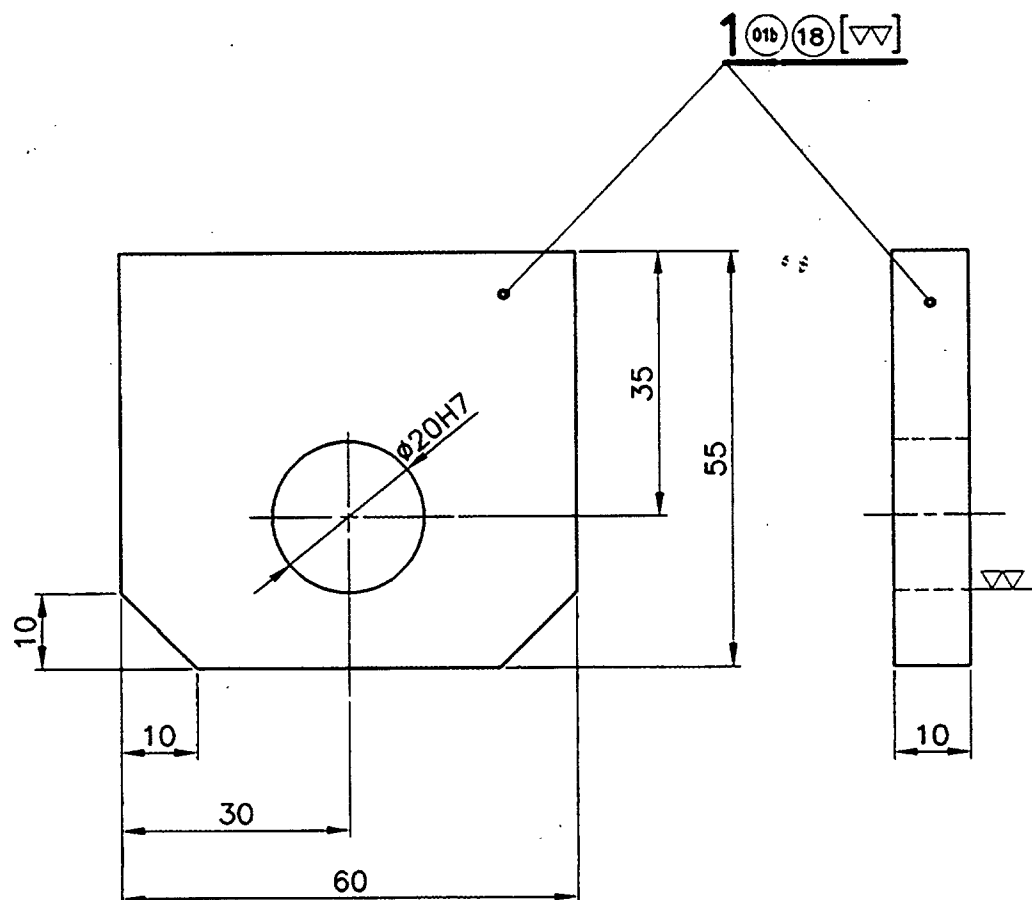

NOTE:

1.FOR UNTOLERANCED DIMENSIOINS REFER DRG. NO. ICF/STD-9-0-001

☒ -EMU/M, DC/EMU/M, DMU/DPC, MEMU/DMC, DHMU/DPC, DHTC, DHTC/J, EMU/M WITH MODULAR TRANSFORMER, ARTV, RRV/J, DETC, DETC/US, AC/DC EMU/M2, AC/DC EMU/C2,C3, AC/DC EMU/D2, AC/DC EMU/D2/HC, AC/DC EMU/D3/HC, AC EMU/M/ASR, AC EMU/C/ASR, AC EMU/D/ASR, DMU/DPC5,6&7 DC/EMUM/ASR, DC/EMU/H2, EMU/2C/ASR, EMU/2D/ASR

24	LUG	10x55x60	1	R101588014	IRS M41-97	
NO. OFF	DESCRIPTION & DIMENSIONS		ITEM	REF.DRG	MATL SPEC.	REMARKS
IV III II I	GROUP: BOGIE FRAME ARRGT. (0-3)					SUPERSEDED BY
	LUG					SUPERSEDES EMU/M-0-3-053 alt.c/2
						SCALE 1:1
						SSE CHD CAD DRN
						ALT d
						INTEGRAL COACH FACTORY CHENNAI - 600.038
						EMU/M-0-3-053

CAD FILE: C:\MD-CAD\089\0-3\053-SD02.DWG

DATA CODE

089

INDIAN RAILWAY
STANDARDS

SHEET
1 OF 1

30.8.2002			
DATE	Dy.CME/D	SME/BD	